

# 10 Turn-Motorized potentiometer drive 10 Gang-Motorpotentiometerantrieb

## Serie MPZD

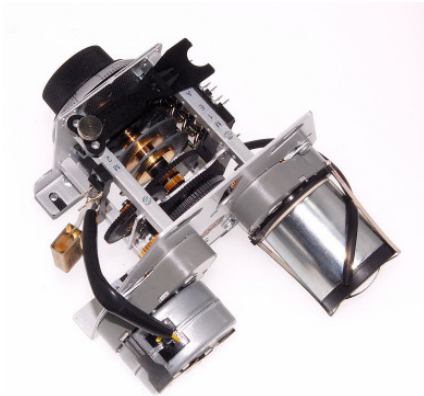

- 1-3 Feindrahtpotentiometer 2W/100 Ohm – 20 KOhm / Precision 10 turns potentiometer
- 2 Hochlaufzeiten / 2 Cycle time:  
T1 = schneller Rücklauf / fast zero set  
T2 = Programmablauf Max./Min. / Program duration Max./Min.
- 2 programmierbare Endlagekontakte / 2 Adjustable limit switches
- 1-7 programmierbare Nutzkontakte / 1-7 Adjustable program channel

### Application:

- Motorized potentiometers are basically the best in the field of control and regulation technics
- The possibility to mount several potentiometers on the same shaft allows also a remote display of the position of the potentiometer
- Supplementary cams can be used to give limit signals depending on the position of the potentiometer
- Supplementary cams can also be used to offset a residual resistance of the potentiometer at the zero point
- One supplementary cam can be used as zero point interlocking

### Design:

- High precision wire-wound potentiometer with high resolution and linearity
- Potentiometer directly driven by the cam shaft
- Two adjustable limit switches controlling the rotation angle of the potentiometer
- Solid mechanical Stopps preventing damage to potentiometers
- Available with AC or DC motors
- Friction clutch protecting the unit when manually operated
- The modular design allows quick delivery practically without delay, voltage resistance and cycle time according to your requirements

### Outline drawing

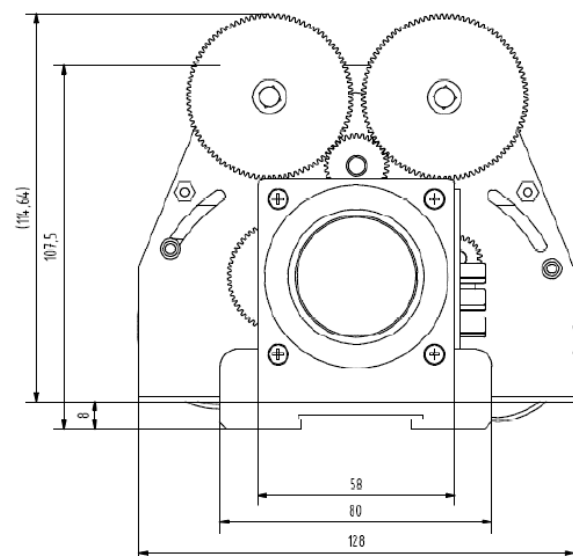
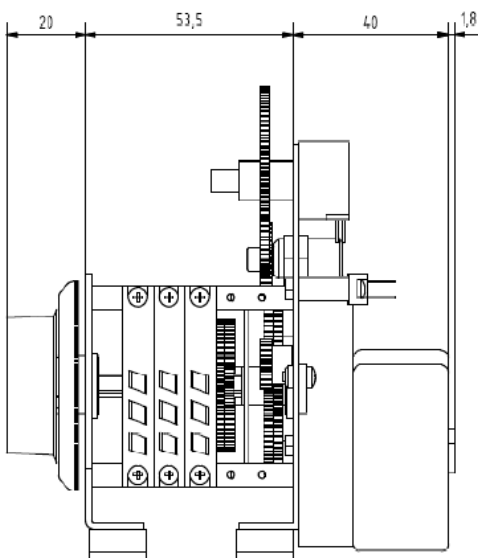

**Serie MPZD**

**Order key**

MPZD41 04 1 1 C1 C1 1 1

Dimension / Size (mm) / Number of switches:

4 -->Dimension 55 mm -->Size (L) <b>04</b> = 2 Switches 2 Adjustable limit switches (NK4101/20°) + 0 Program channels free setting (NK4201)
5 -->Dimension 63 mm -->Size (L) <b>05</b> = 3 Switches 2 Adjustable limit switches (NK4101/20°) + 1 Program channels free setting (NK4201) 1 Program key (PSN)
6 -->Dimension 71 mm -->Size (L) <b>06</b> = 4 Switches 2 Adjustable limit switches (NK4101/20°) + 2 Program channels free setting (NK4201) 1 Program key (PSN)
9 -->Dimension 95 mm -->Size (L) <b>09</b> = 7 Switches 2 Adjustable limit switches (NK4101/20°) + 5 Program channels free setting (NK4201) 1 Program key (PSN)

Cycle times (T1):

1 = 30s 2 = 60s 3 = 100s 4 = 150s 5 = 180s 6 = 300s  
7 = 10min. 8 = 15min. 9 = 20min. 10 = 30min. 11 = 60min.

Cycle times (T2):

1 = 30s 2 = 60s 3 = 100s 4 = 150s 5 = 180s 6 = 300s  
7 = 10min. 8 = 15min. 9 = 20min. 10 = 30min. 11 = 60min.

Synchronous motor 1: Power supply (AC / DC) Frequency 50Hz (60Hz)

	CW	CCW	
<b>C1</b> = 24	/ 24V		AC
<b>C2</b> = 48	/ 48...	50V	AC
<b>C3</b> = 110	/ 110...	120V	AC
<b>C4</b> = 220	/ 220...	240V	AC
<b>G1</b> = 24	/ 24V	± 0.1	DC
<b>G2</b> = 12	/ 12V	± 0.1	DC On request

Synchronous motor 2: Power supply (AC / DC) Frequency 50Hz (60Hz)

	CW	CCW	
<b>C1</b> = 24	/ 24V		AC
<b>C2</b> = 48	/ 48...	50V	AC
<b>C3</b> = 110	/ 110...	120V	AC
<b>C4</b> = 220	/ 220...	240V	AC
<b>G1</b> = 24	/ 24V	± 0.1	DC
<b>G2</b> = 12	/ 12V	± 0.1	DC On request

10-Turn-Precision wire wound potentiometer (Type DPZ, 2W): Resistance

1 = 100Ω 2 = 200Ω 3 = 500Ω 4 = 1KΩ  
5 = 2KΩ 6 = 5KΩ 7 = 10KΩ

10-Turn-Precision wire wound potentiometer (Type DPZ, 2W): Resistance

8 = 20KΩ 9 = 50KΩ

Ex.: MPZD4105-1-C4-C4-718 meant for the potentiometer choice:  
R1=10KΩ, R2=100Ω, R3=2.5KΩ

Special products will be produced under a new article number.